

sinar+

p3

The Sinar Camera System



Your Solution Provider
for Professional Photography



Photo: EL CORTE INGLES S.A ©



The View Camera: Essential Tool for Numerous Applications in the Digital Era

The Sinar View Camera with its versatile accessory modules produces an image quality of highest level. It provides professional performance without compromises, creative composition as well as true to original reproductions, all of this within a clearly defined workflow. Perspective and sharpness, the most important creative tools, are controlled and evaluated directly at the camera. Time-consuming, inefficient and costly subsequent manipulations on the computer coupled with visible losses of quality, are eliminated.

The rules and fundamentals of optics have not changed, but cameras and lenses have evolved enormously in terms of resolution and image quality. Specific system configurations that incorporate these new developments take full advantage of the resolving power of today's digital backs and they deliver a most impressive increase in quality.

The Advantages of Swings, Tilts and Shifts

- Manipulation and adjustment of perspective
- Enhanced creativity by control of perspective
- Correct proportions from every camera position
- Sharpness gradient and selective sharpness or unsharpness
- Selective definition of the depth of field and the area of sharpness
- Correct proportions and undistorted angles
- Subsequent software corrections of image distortions are eliminated

Adapting Digital Backs

Thanks to the unique self-locking gears, the yaw-free design and the highest precision in manufacturing the Sinar p3 camera system sets a standard in the professional studio photography.

All digital backs whatever manufacturer can be mounted on the camera platform. With the appropriate Sinar accessories users of third-party digital backs also benefit from the substantial advantages and functionality. Dependent on integration of live image the adaption takes place either with the Sinar Sliding Adapter or with a specific Sinar adaptation plate.





Lens Hood with Bellows



Lens Hood without Bellows



Conversion Set Sinar p2/p3



Lens Adapter Rings



Multipurpose Standard 100

Lens Hood with Bellows

The lens hood can be used with or without an LC shutter and it consists of the following components:

Lens Adapter Ring	547.81.xxx
Bellows-/Filter Holder 100	473.41.000
Tapered Bellows	452.16.010
Rod Holder 100	472.41.000
Rod 16 cm	472.71.000
Rod 25 cm	472.81.000
Bellows Holder Clip	473.31.000

Lens Adapter Rings 547.81.xxx

A Lens Adapter Ring is used for attaching Sinar accessories such as an LC Shutter or a lens hood mask and it is screwed into the filter thread on the front of the lens. The inside diameter of the adapter ring is defined by the lens that is being used, its outer diameter conforms to the Sinar p3 standard dimension of 100 mm. Lens Adapter Rings are available for filter thread sizes from M40.5 to M95.

Conversion Set Sinar p2/p3

With this Conversion Set, the Sinar p2 and Sinar x view cameras of the earlier generation can be upgraded very conveniently to a modern Sinar p3 camera. The Conversion Set consists of the following components:

Carrier Frame 100 of the rear standard	433.81.010
Carrier Frame 100 of the front standard	431.81.010
Multipurpose Bellows 100 EL	454.12.000
Release Lock p3	531.81.000
Depth of Field Scale, digital	

Lens Hood without Bellows

This solution offers an alternative to the above configuration and it consists of the following components:

Lens Adapter Ring p3 / artec / lanTec	547.81.0xx
Lens Shade	493.23.041

Multipurpose Standard 437.63.000

Equipped with swing- and shift mechanisms, the Multipurpose Standard 100 serves as an intermediate standard for long bellows extensions. It is recommended when a Sinaron Digital 5.6/120 mm Macro Lens is being used for an image ratio greater than 1:1.

Horizontal shift: +50/-22 mm
Vertical shift: 55 mm
Swing: +/- 40°
Tilt: +/- 40°

Bellows-/Filter Holder 473.41.000

The Bellows-/Filter Holder 100 is attached to the front of the lens by means of a Lens Adapter Ring. It permits the use of a 100 x 100 x 1 mm filter as well as a Sinar Bellows with a 100 mm frame.





Sinar LC Shutter



Sinar Rail Extension



Sliding Adapter



Bellows



Sinar Modular System Solutions

Sinar View Camera Systems – Innovative Swiss precision products – are optimized for digital professional photography.

The world of professional photography has changed a lot over the time. The demand for quality continuously increases covering an ever larger spectrum. Sinar View Cameras are used wherever professionalism, unrestricted creativity and entrepreneurial work are essential and where a quality-conscious photographer is determined to stand out from the middle class.

Thanks to its highly versatile and continually effective modularity, the Sinar System is the only one that is based on the premise of meeting all of these demands. There is a large number of Sinar View Cameras in daily use around the world and they are essential for an efficient workflow and the quest for 'Premium Quality' images.

Sinar LC Shutter 551.65.020

The Sinar LC Shutter is an exclusive Sinar feature that, in combination with Sinar Digital Backs, produces live images of the very highest quality. The live image produced with an LC Shutter is clearly superior to a software-controlled live image. The computer monitor becomes a large-format focusing screen.

Sinar Bellows

- 100 EL Wide-angle 455.12.000
Maximal extension: 12 cm
- 100 EL (Standard) 454.12.000
Maximal extension: 15 cm
- 100 EL long 454.12.001
Maximal extension: 30 cm
- Tapered Bellows 4x5/100 452.16.010
Maximal extension: 20cm
- 100 Multipurpose Bellows without contacts 454.12.010

Sliding Adapter 551.32.192

With its bright and crisp contrast focusing screen image, the Sinar Sliding Adapter provides problem-free operation with quick change-overs from focusing to exposure readiness. An attachable, flexible magnifier permits safe and precise focusing that delivers a clear focusing screen image, even with tilts. The Sinar Sliding Adapter also serves as an interface when other makers' digital backs are to be used on a Sinar p3 camera. Several medium-format camera adapters are available for this purpose: Sinar Hy6, Hasselblad V, Hasselblad H, Mamiya 645 AF and Contax AF.

Joint Rod 2 472.51.010

This Joint Rod is equipped with two lockable ball-and-socket joints and it can be extended to a length of approximately 30 cm.



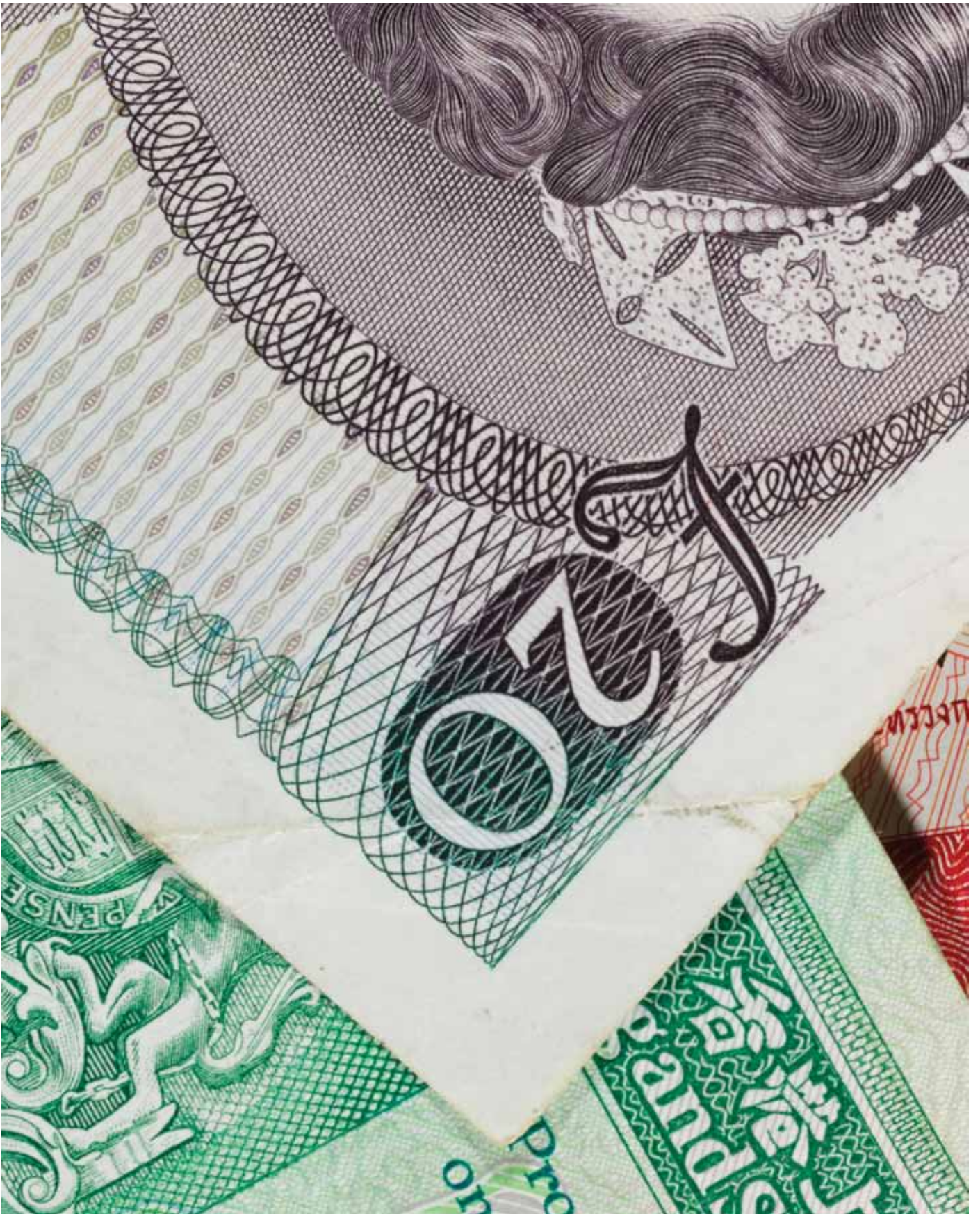

Photo: David Mitev ©



Precision and great Ease of Operation

The legendary precision of Sinar view cameras for analog and digital studio photography is already very well known and highly valued by a great number of users around the world. Based on the same standards, the Sinar rePro is specifically designed to meet the requirements of reproduction photography. The Sinar rePro fits seamlessly in the universal Sinar System and it provides an easy workflow with maximum accuracy. An investment that pays for itself.

The Professional Tool for Reproduction Photography

With the growing demand for digitization and archiving, the requirements on camera systems for reproduction photography have changed significantly. Essential aspects in the success of a modern reproduction camera are ease of operation and precision. Large volumes of objects to be digitized require optimal workflow, needless to say that exposures which have to be repeated cause major waste of time resulting in extra costs. These criteria have been taken into account during the design and development process of the Sinar rePro. The result is a professional tool that meets the requirements for reproduction photography with Swiss perfection.



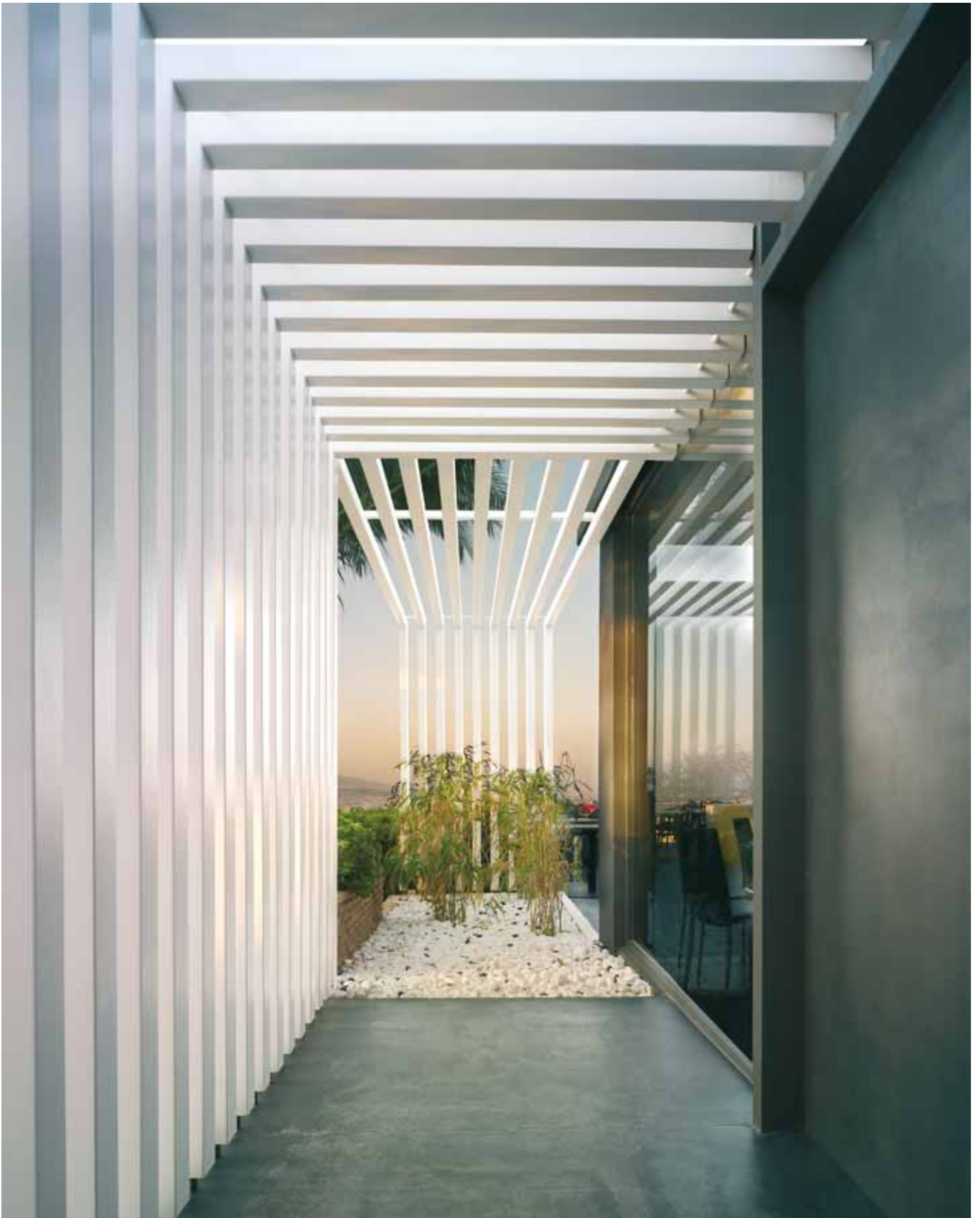

Photo: Panagiotis Papavasiliou ©



The Workflow-Oriented Camera System

The Sinar arTec and lanTec models fit seamlessly in the universal Sinar System and they allow a simple workflow with maximal flexibility. An investment that pays for itself!

The two Sinar camera systems feature excellent user friendliness and precision that is evident through the superb image quality. The Sinar software encompasses unique tools that are particularly useful in architectural applications and that provide optimal support for the workflow of the architectural photographer. The Sinar arTec has the same mechanical interface as current medium format cameras and the Sliding Adapter of the Sinar p3 view camera. That makes it easy to adapt all digital backs to change from an architectural- to a medium format- and to a view camera. In addition, many accessories from the universal Sinar System can also be used on the Sinar arTec and lanTec cameras.

Professional Camera Systems for Landscape- and Architectural Photography

Mobile Sinar camera Systems establish standards in digital photography. Never before have camera systems been tailored so accurately to the particular requirements of professional architectural- and landscape photography. The results of intensive market survey are evident in every aspect. With its two camera models arTec and lanTec, Sinar offers two mobile camera systems that stand out for their superb manufacturing quality and precision. These unsurpassed precision mechanical masterpieces are the result of decades of experience in the meticulous manufacture of premium products for high-end photography. The perfect harmonization of highly precise mechanical components and advanced optics lead to images with unsurpassed detail sharpness.

Sinar lanTec

Thanks to its ergonomically shaped handles, the Sinar lanTec is immediately recognizable as a professional mobile camera solution. The balanced handling of the Sinar lanTec enables the photographer to create images of the highest quality, even in handheld operation, and this gives the Sinar lanTec a broad field of applications. The Apple iPhone and iPod touch can be connected to serve as viewfinders that provide brilliant images for composing and focusing.



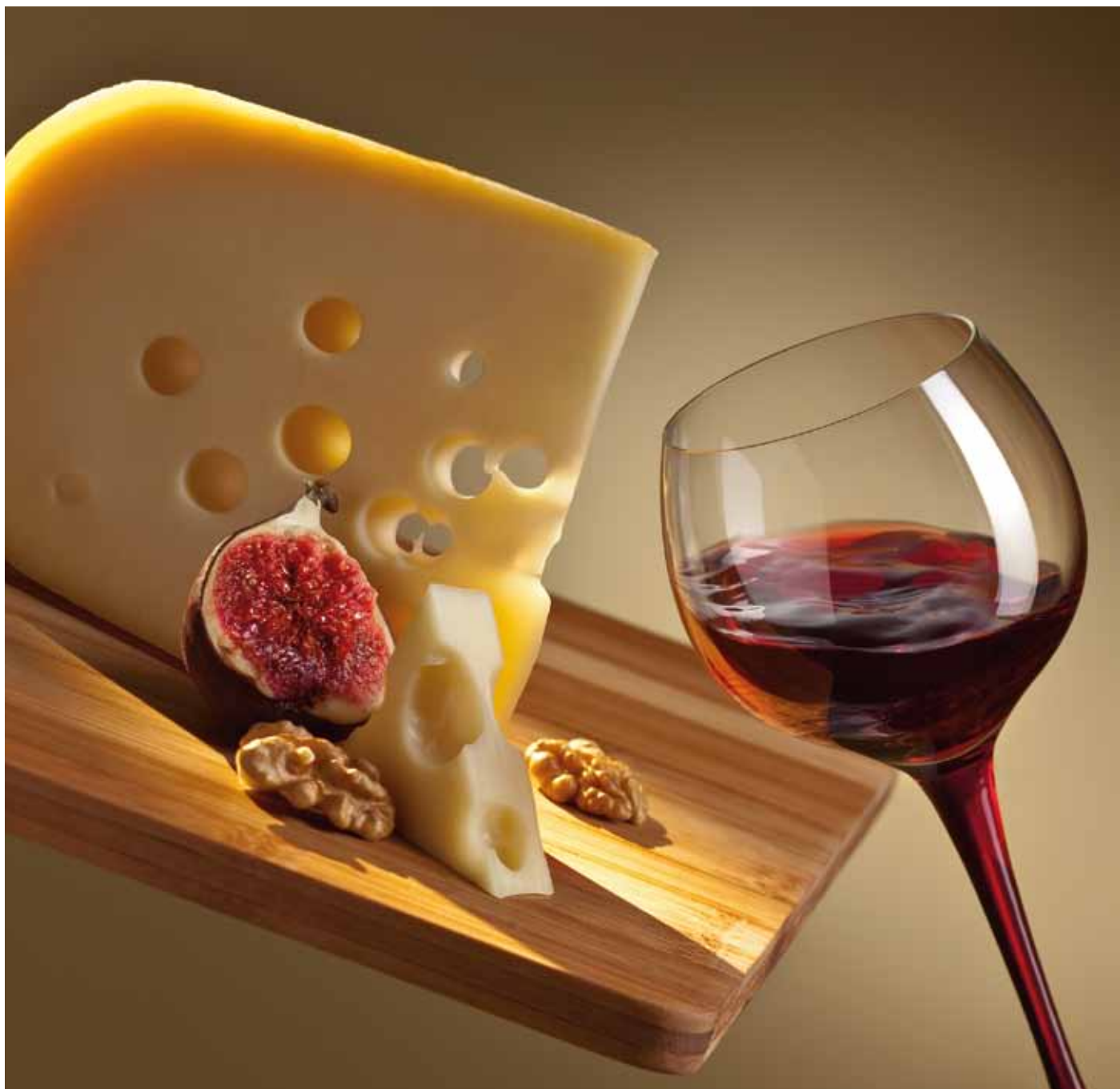

Photo: Dimitar Mitev ©



Flexibility and Creativity

Sinar is the leader in manufacturing of precision view cameras for more than 60 years. The Sinar p-slr corresponds to the highest camera precision “Made in Switzerland”, including ergonomic design and unlimited creative freedom. The human hand serves as reference for size, shape and handiness, so that it is easy to operate accurately and comfortably, even in darkened rooms. Lenses and bellows can be changed quickly and safely by mere finger pressure on practice-based locking mechanism. External styling elements grant the Sinar p-slr a trendy appearance.

Self-locking fine focusing gears guarantee highly accurate adjustments – the camera remains exactly in the adjusted position. All relevant elements for composing the image are available, like swings and tilts of the front and rear standard (Scheimpflug), as well as horizontal and vertical shifts.

The Professional Extension for 35 mm Cameras

The Sinar p-slr was designed especially for photographers who wish to take advantage of the unique advantages and quality characteristics of a Sinar view camera in conjunction with their single lens reflex cameras. Exact control of perspective and selective sharpness, the most important creative tools in photography, are set and evaluated precisely on a view camera.

In addition, this meticulously thought-out solution offers the benefit of a distinct increase in quality by using high-resolution Sinaron lenses designed specifically for digital imaging.

Quick Clamping Adapter

The Sinar p-slr can be used with digital SLR cameras from Leica, Canon and Nikon. With the Quick Clamping Adapter that is supplied with the Sinar p-slr, the change from vertical to horizontal format can be performed within seconds and with only a few hand movements.





Photo: János Rátki ©



Sinar eShutter



Sinar CMV Shutter



Sinar CPL Shutter

Sinar CPL Shutter

Sinaron Digital CPL Lenses can be used with the following view cameras: Sinar p3, Sinar p3 SL, Sinar f3 and Sinar f3 SL

Sinaron Digital CPL lenses mounted on 100 mm lens boards are available in focal lengths ranging from 28 mm to 210 mm

Sinar Digital CPL Lenses are set completely manually. They do not require computer software nor an electrical power supply.

Sinar CEF Shutter

Lenses for use on arTec and lanTec cameras are focused by means of helical focusing mounts.

Sinar CMV Shutter

Sinaron Digital CMV Lenses can be used on Sinar p3, Sinar p3 SL, Sinar f3 and Sinar f3 SL view cameras.

Sinaron Digital CMV Lenses and lens boards with 100 mm side dimensions are available with focal lengths ranging from 28 mm to 180 mm

The compact between-the-lens shutters of the Sinaron Digital CMV lenses offer shutter speeds to 1/60 of a second and they are controlled with highest accuracy by the Sinar exposure software. The aperture is set manually.

Progress with a System

The Sinar eShutter is fully integrated into the Sinar System and thanks to its open architecture it can also be used with all the other manufacturers' systems. The design permits unrestricted conversions of existing lenses size 0 and it provides an attractive entry into the Sinar eShutter System.

Standard control and operation of the Sinar eShutter is performed with a Mac or a PC via USB interface. An exciting innovation is the intuitive operation by means of the most modern and widespread communication tools like the Apple iPhone, iPad or iPod touch. Trendy technologies, which not only stand for innovation, but which also guarantee a much more efficient and pleasant way of working.





Photo: Mathias Hofstetter ©



Sinar eXact



Sinar eVolution 86H



Sinar eVolution 75H

Sinar Digital Backs meet the Highest Quality Demands

Sinar One- and Multishot digital backs stand for the uncompromising dedication to the highest digital image quality. All Sinar digital backs deliver results that are clearly unsurpassed in terms of color accuracy and color resolution. Based on the well-proven Sinar Microscan Technology, the Sinar eXact achieves data sizes of up to 576 MB (RGB/8 bit) in impressive multishot quality. Thanks to the downscaling function, image data sizes of 12 up to 192 megapixels can be achieved with a single digital back, giving the Sinar eXact a broad range of new fields of applications.

Sinar eXact From 12 MP to 192 MP

This is the very first time that a manufacturer offers a unique digital back that covers the entire range from packshots all the way to absolutely high-end photography. The option of the downscaling function, coupled with the multishot technology allows flexible applications that have never been possible before now.

Everything in a single product, so that your requirements are met for every assignment, today and tomorrow. And that in the familiar Sinar high-end quality in all its applications!

When a Single Exposure is not Sufficient for the Best Image

Wherever work is being performed in the field of still-life photography or image archiving, there are Sinar Digital Backs in use. Multishot backs produce 4x higher color resolution than simple Oneshot models. Such differences are obvious and they cannot be compensated by means of high-performance Oneshot products.

With 4-shot exposures, the CCD pixel matrix is shifted 3-times from one exposure to the next by exact width of one pixel raster, so that every picture point is captured in each one of the primary colors (red, blue, 2x green). Another decisive argument in favor of the multishot technique is the clearly reduced Moiré effect, which, because of the controlled layering of colors, becomes barely noticeable. With this exposure technique, the image interpolation that is needed with oneshot backs, can be omitted completely.

SINAR - MODULAR SYSTEM SOLUTIONS

Sinar View Camera Systems – Innovative Swiss precision products – are optimized for digital professional photography.

The world of professional photography has changed a lot over the time. The demand for quality continuously increases covering an ever larger spectrum. Sinar View Cameras are used wherever professionalism, unrestricted creativity and entrepreneurial work are essential and where a quality-conscious photographer is determined to stand out from the middle class.

Thanks to its highly versatile and continually effective modularity, the Sinar System is the only one that is based on the premise of meeting all of these demands. There is a large number of Sinar View Cameras in daily use around the world and they are essential for an efficient workflow and the quest for 'Premium Quality' images.

10 GOOD REASONS FOR CHOOSING SINAR

- For more than 60 years Sinar is the leading supplier of view camera system solutions.
- The unique modularity of the Sinar view camera system ensures the compatibility of today's Sinar p3 camera all the way back to the successful Sinar p introduced in 1970 – and into the future.
- Sinar has been the first manufacturer of view cameras to recognize the needs of professional digital photography appropriately.
- Sinar has been offering modern system solutions for medium format photography since the year 2000.
- Sinar is the leading manufacturer of digital backs with single-shot and multi-shot functionality.
- Sinar offers an open system for digital backs from Sinar and from other suppliers.
- All components of the Sinar Camera System are tailored to the high demands of professional photography.
- The continuous quality chain – from the lens all the way to the digital back and accessories guarantees a decisive competitive advantage.
- These factors make an economic decision for Sinar products and systems a very safe long-term investment.
- The Sinar brand is a quality seal for Swiss dependability and high quality.